

OPTIONAL WIPER GASKET

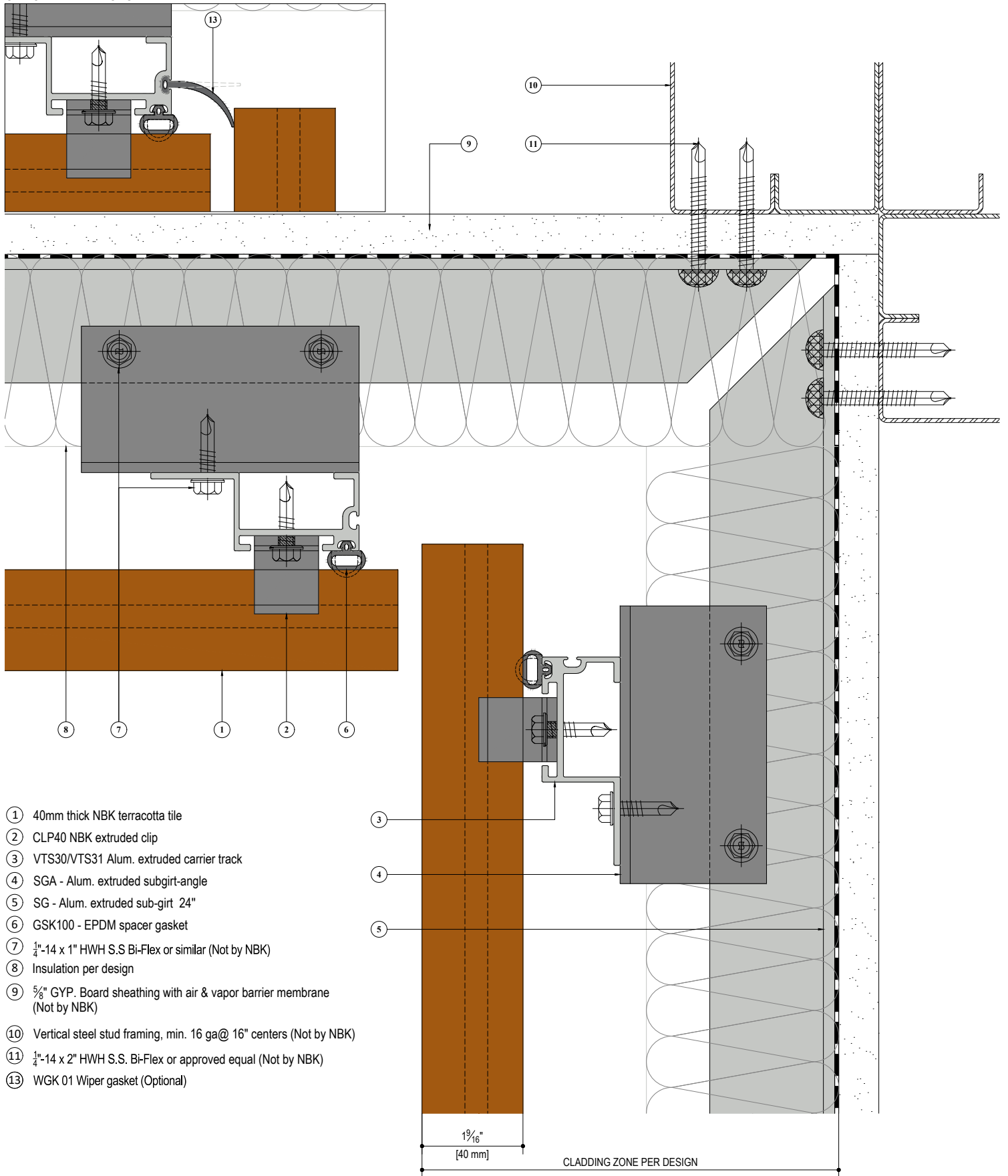

- ① 40mm thick NBK terracotta tile
- ② CLP40 NBK extruded clip
- ③ VTS30/VTS31 Alum. extruded carrier track
- ④ SGA - Alum. extruded subgirt-angle
- ⑤ SG - Alum. extruded sub-girt 24"
- ⑥ GSK100 - EPDM spacer gasket
- ⑦ $\frac{1}{4}$ "-14 x 1" HWH S.S Bi-Flex or similar (Not by NBK)
- ⑧ Insulation per design
- ⑨ $\frac{5}{8}$ " GYP. Board sheathing with air & vapor barrier membrane (Not by NBK)
- ⑩ Vertical steel stud framing, min. 16 ga@ 16" centers (Not by NBK)
- ⑪ $\frac{1}{4}$ "-14 x 2" HWH S.S. Bi-Flex or approved equal (Not by NBK)
- ⑬ WGK 01 Wiper gasket (Optional)

SYSTEM: **TERRART 40**

DETAIL: **STANDARD STUDWALL DETAIL**

DETAIL NUMBER: **NBK-HS-40-07**

TILE DIRECTION: **HORIZONTAL**

DRAWING REFERENCE: **TYPICAL INTERNAL CORNER**

SCALE: **1:2**

NBK | ARCHITECTURAL TERRACOTTA
 A Hunter Douglas Company

NBK North America
 10 Federal Street, Second Floor
 Salem, MA 01970
 Telephone: +1 (781) 639 2662
 www.nbkterracotta.com

COPYRIGHT © 2022 All rights reserved